

HARRY J. ENNS WETLAND DISCOVERY

DRAWING OVERVIEW

**BASED ON: EXHIBIT DESIGN
PACKAGE of March 10, 2023**

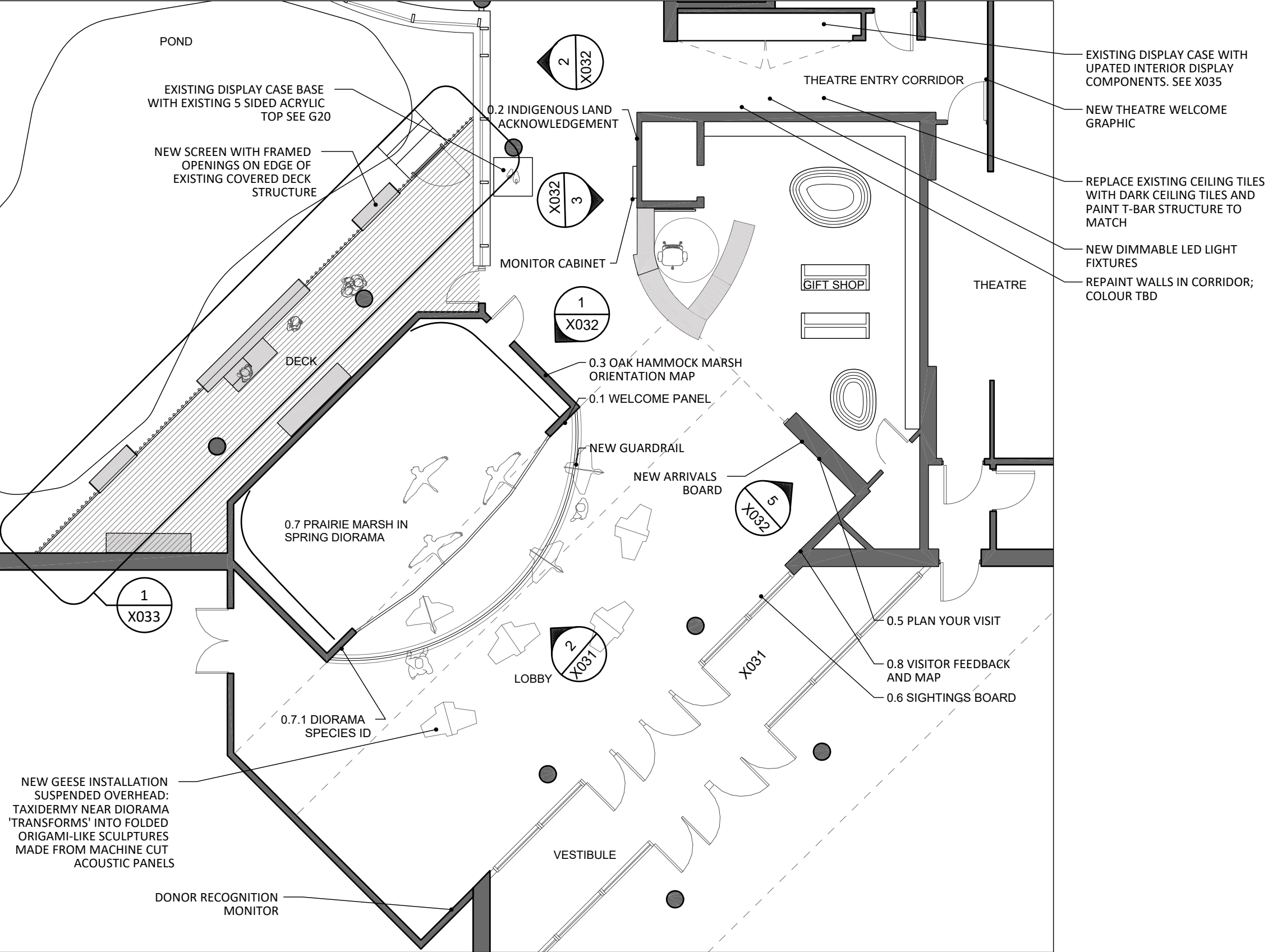



1 Plan of Lobby
Scale: 1:100





Renders for reference purpose only. Some updates to design are not shown.



1

Type 1 Taxidermy
Not to scale

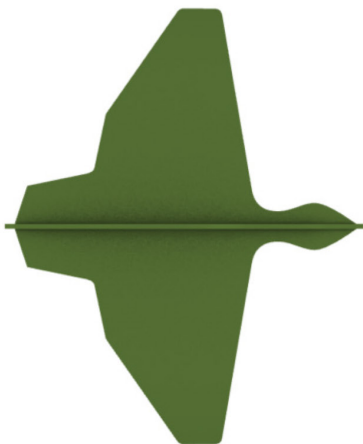

2

Type 2 Hush Acoustics Panel
Not to scale

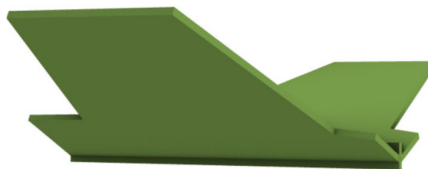

3

Type 3 Hush Acoustics Panel Abstract
Not to scale



4

Type 4 Hush Acoustics Panel: Flutter
Not to scale

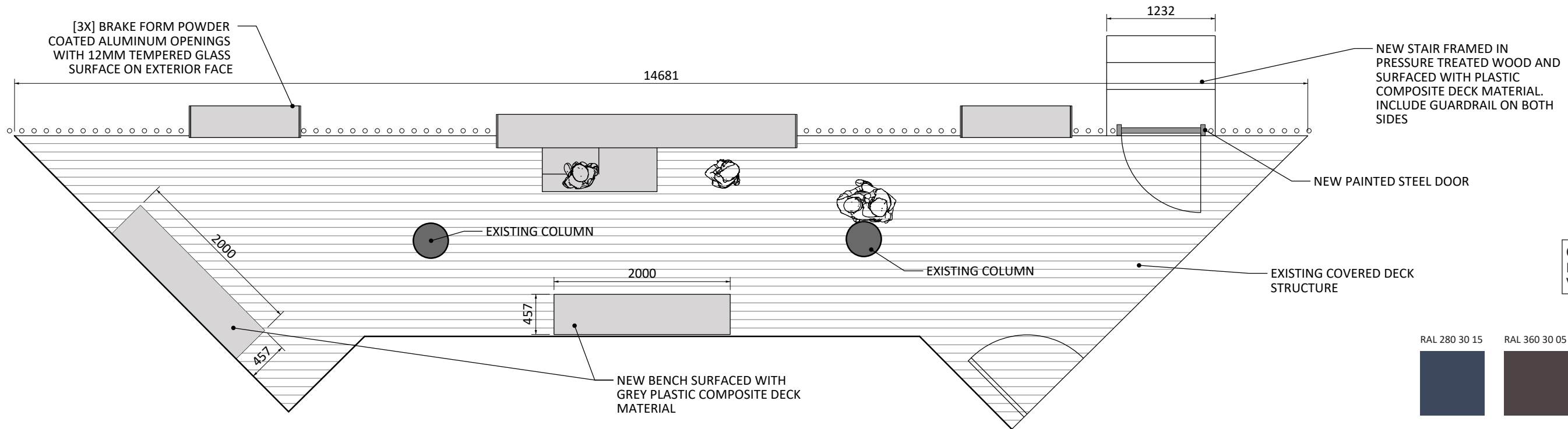

COLOURS FOR METAL POLES: ALTERNATE IN VISUALLY RANDOM ORDER

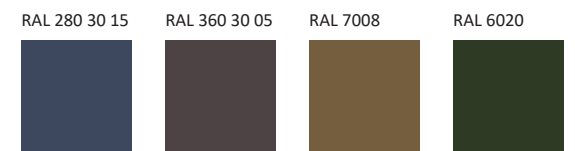

1 Plan of Deck
1:50

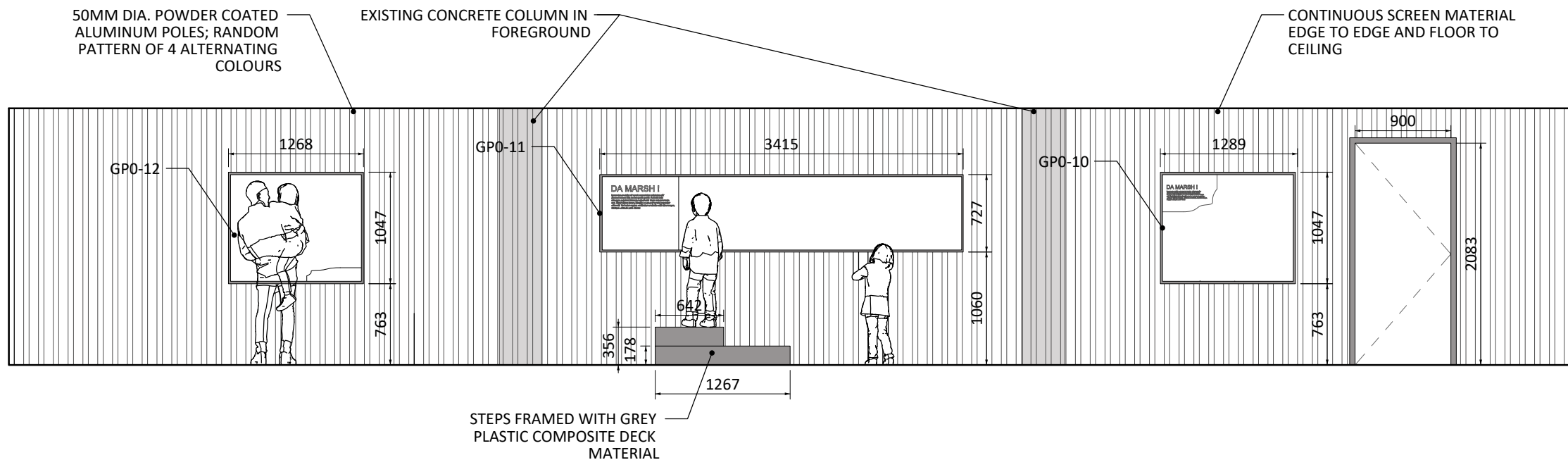

2 Elevation Deck Screenwall
1:50



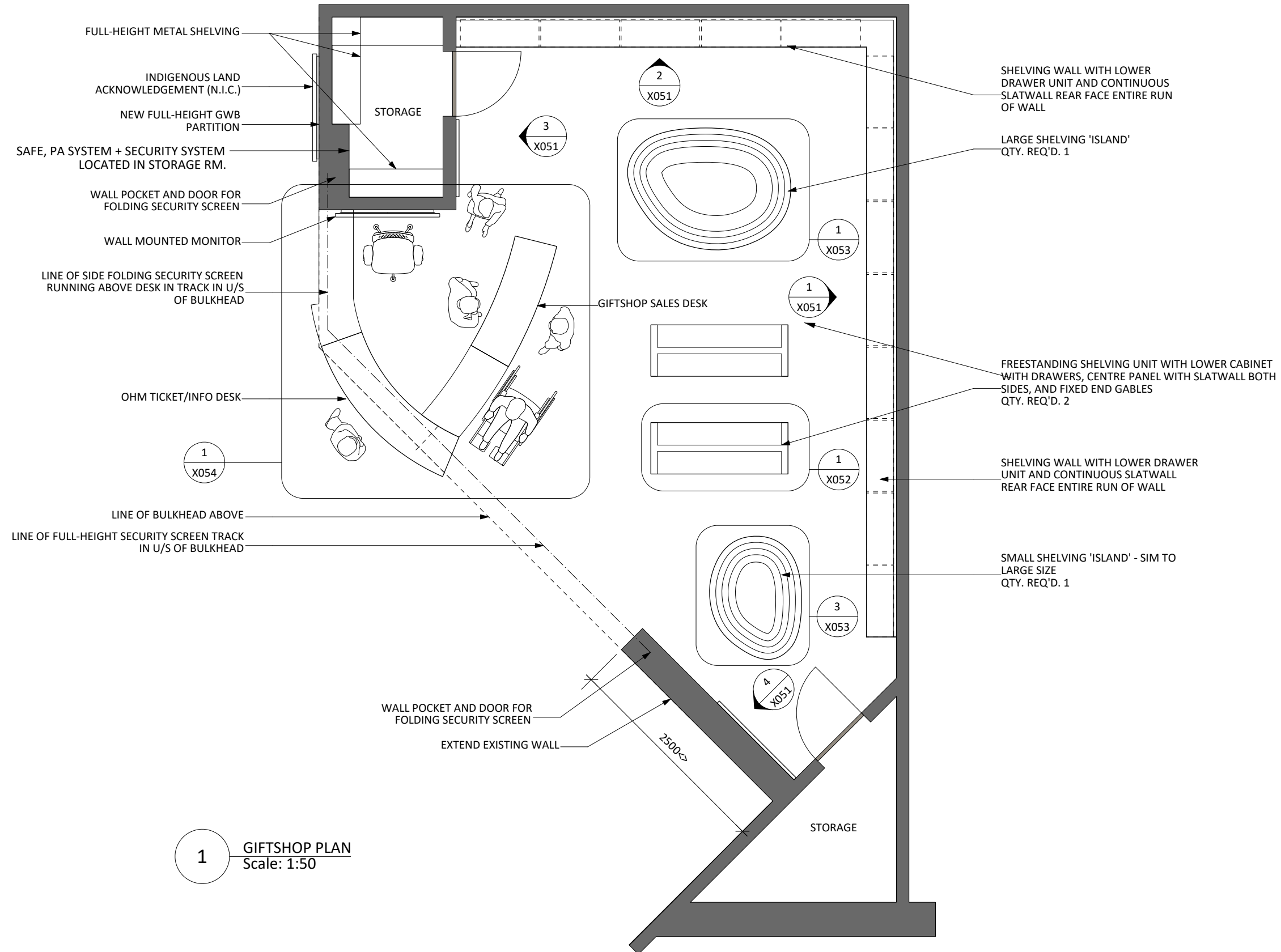

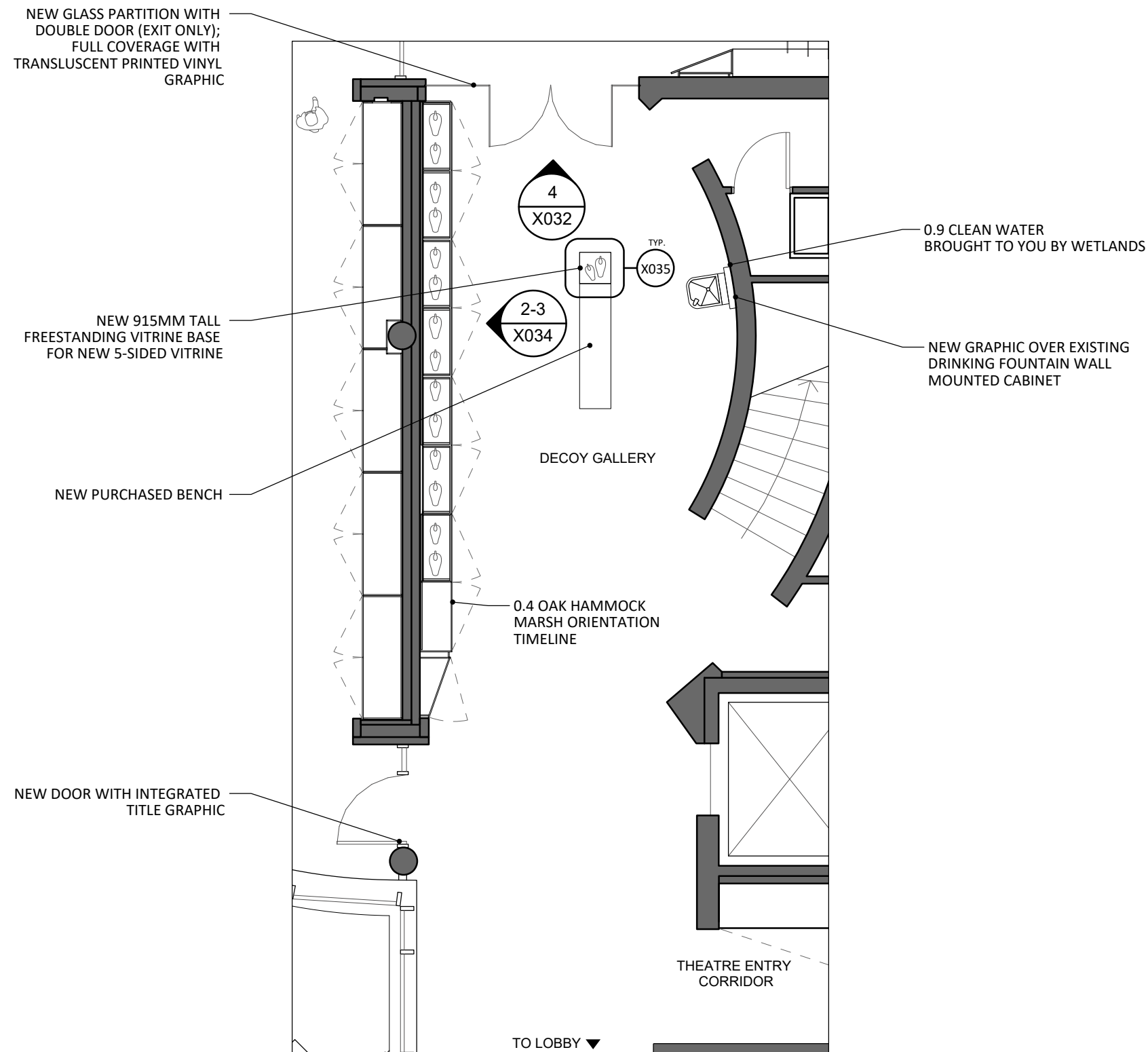

1 Plan of Decoy Gallery
Scale: 1:75



Render Perspective



Render Elevation



NOTE: NOT ACTUAL COLOURS



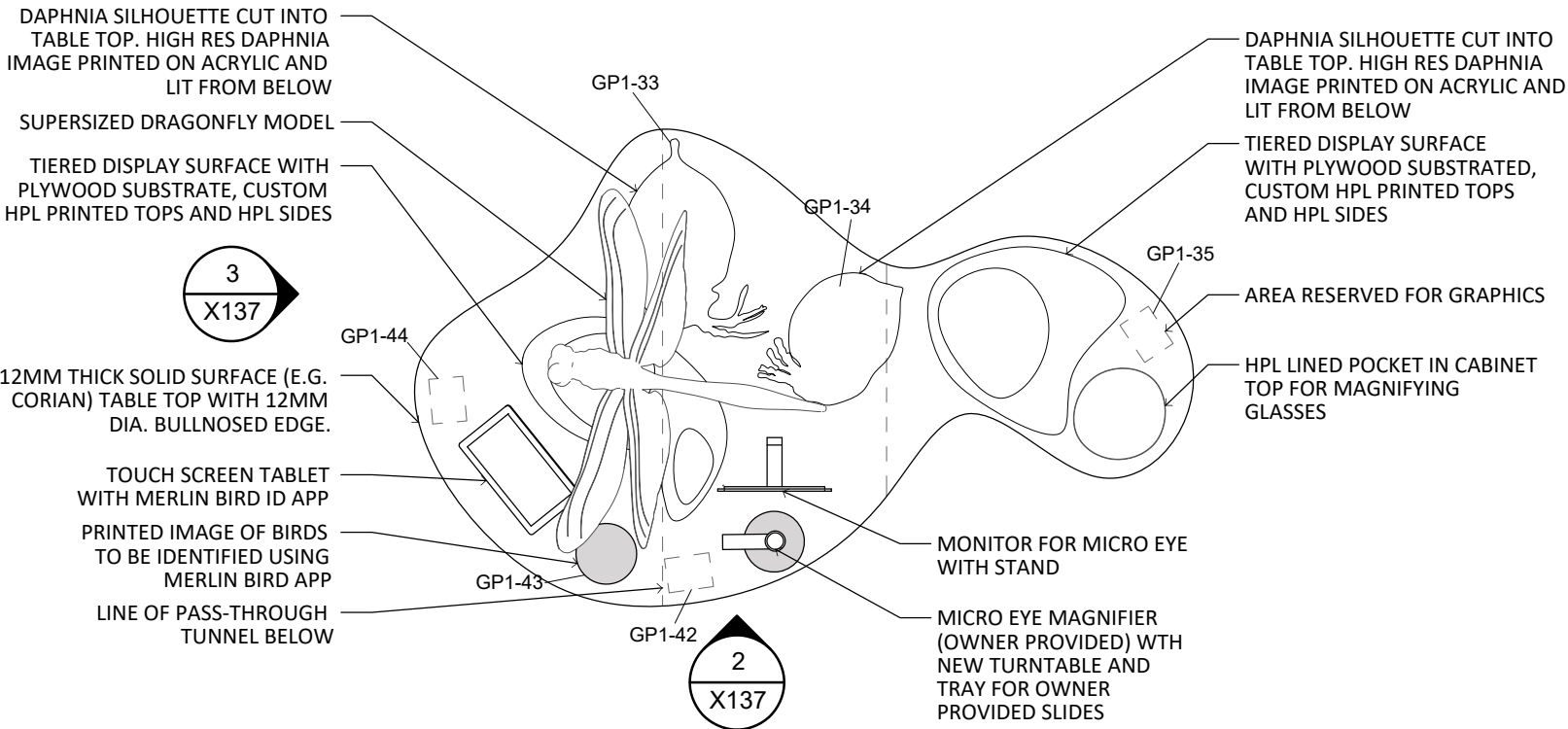

1 Top View
Scale: 1:25

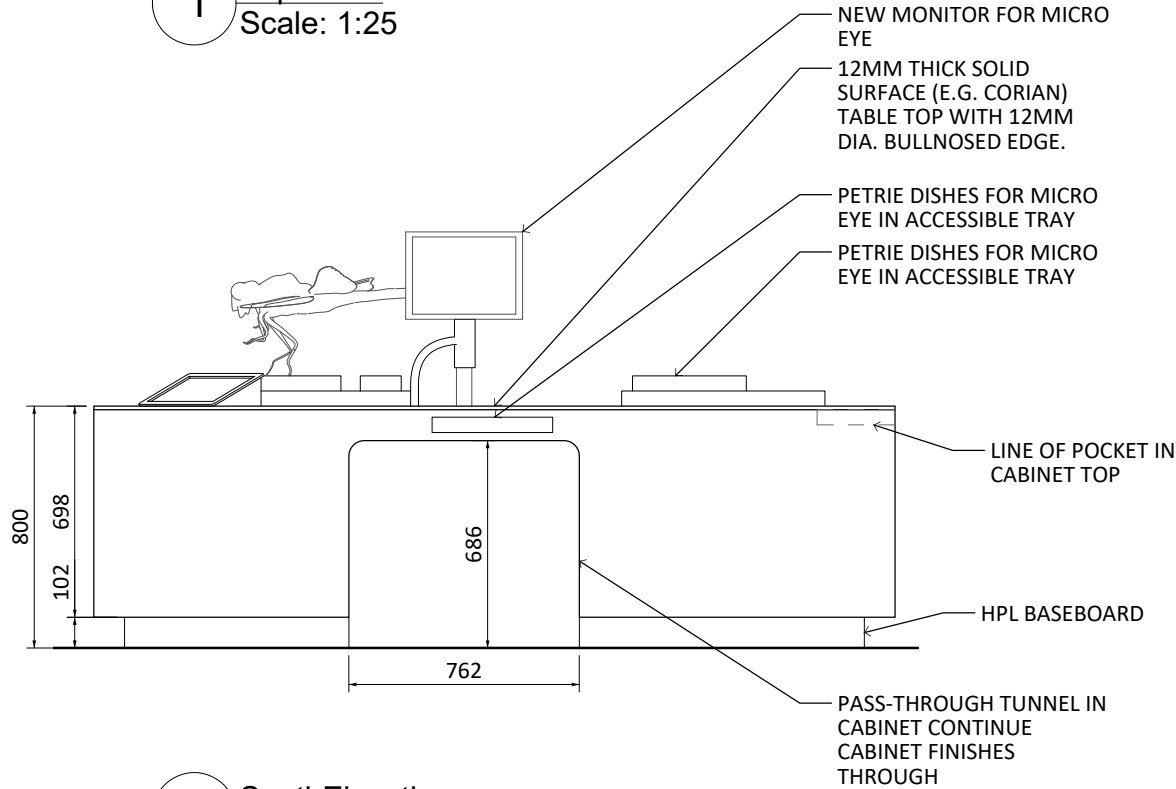

2 South Elevation
Scale: 1:25



NOTE: NOT ACTUAL COLOURS

- MICROEYE VIEWER PROVIDED BY OWNER
- MOUNTED SPECIMENS PROVIDED BY OWNER

4 Perspective

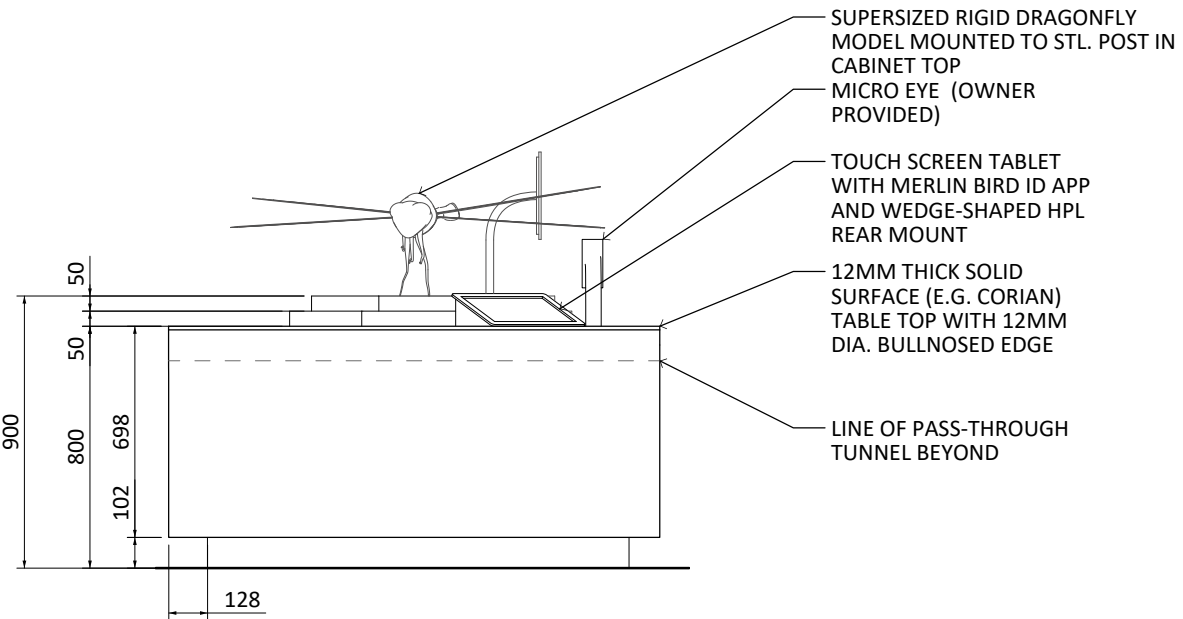

3 West Elevation
Scale: 1:25

MUSKRAT LODGE

PERSPECTIVE VIEWS

NOTE:
1 TAXIDERMY MUSKRAT ONLY SLEEPING WITHIN LODGE

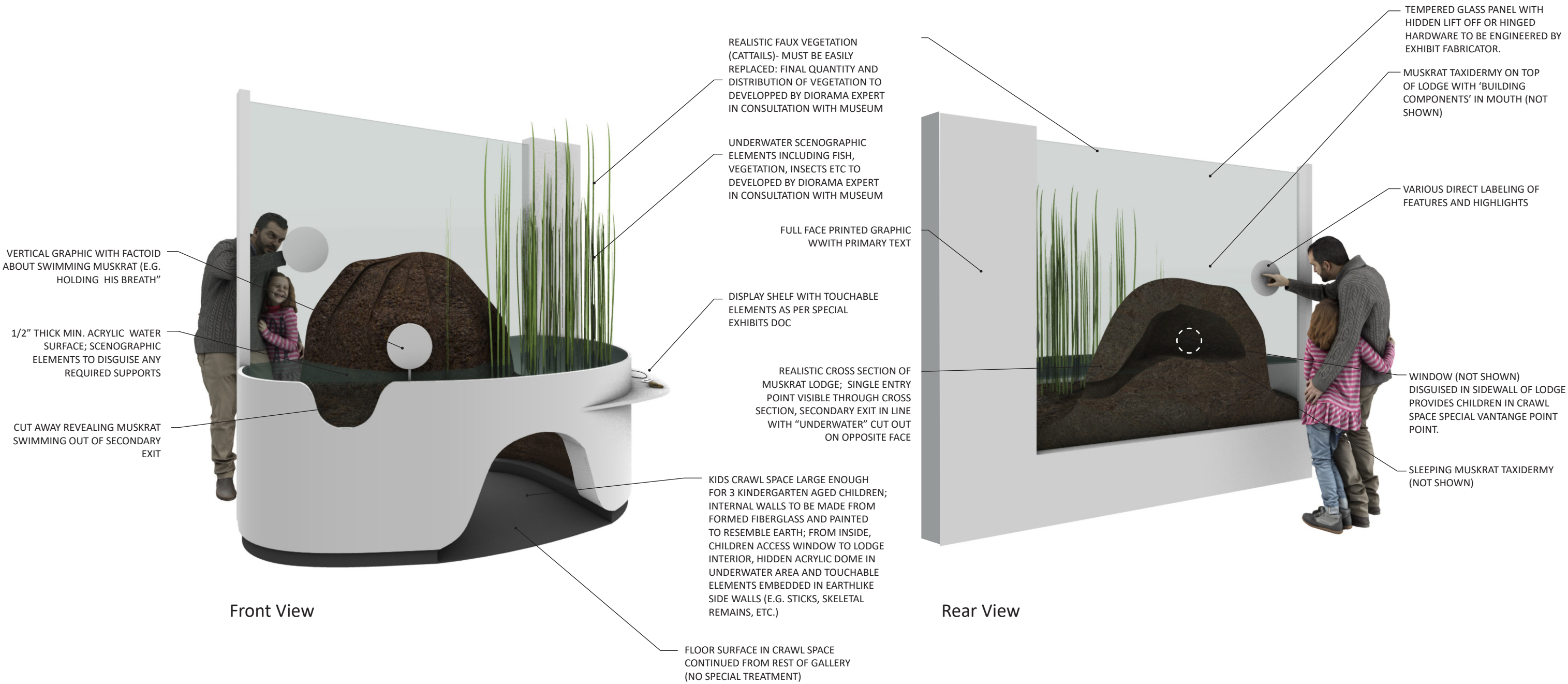

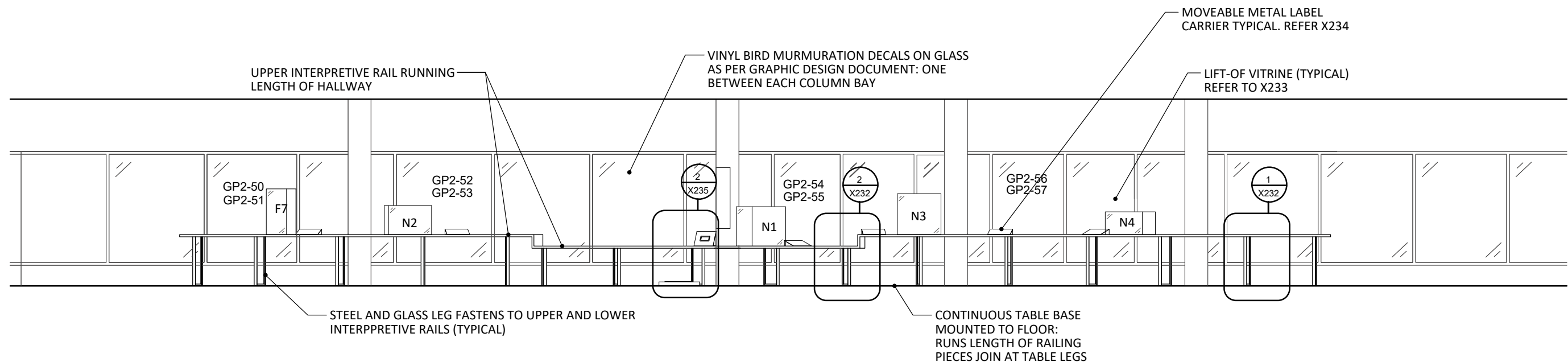
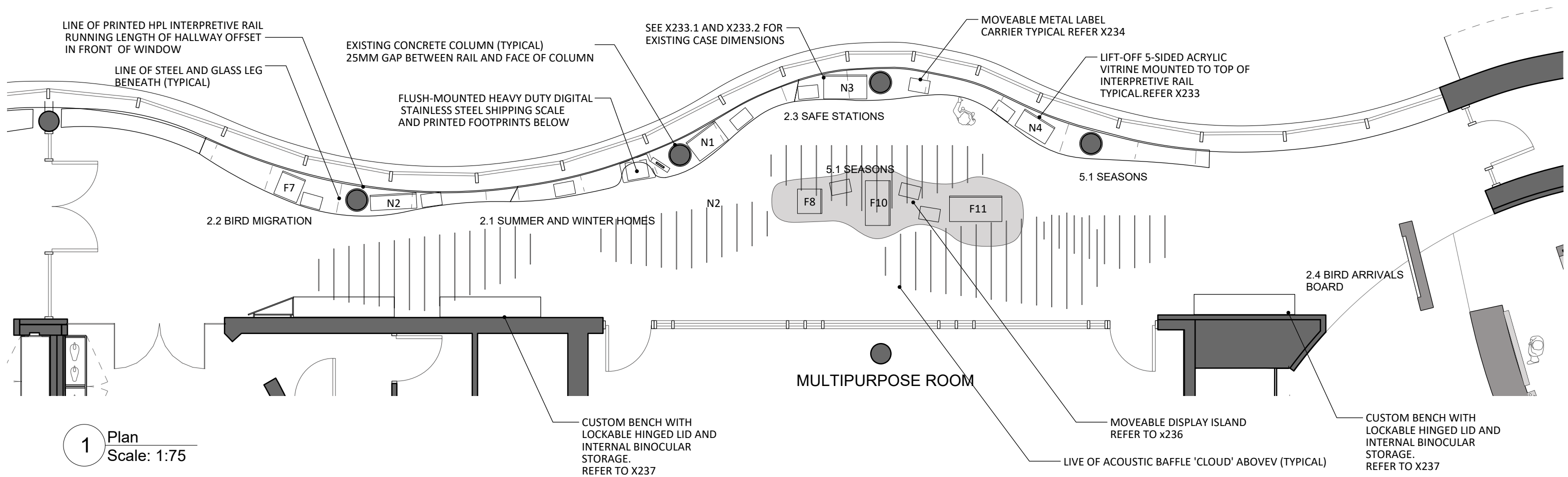



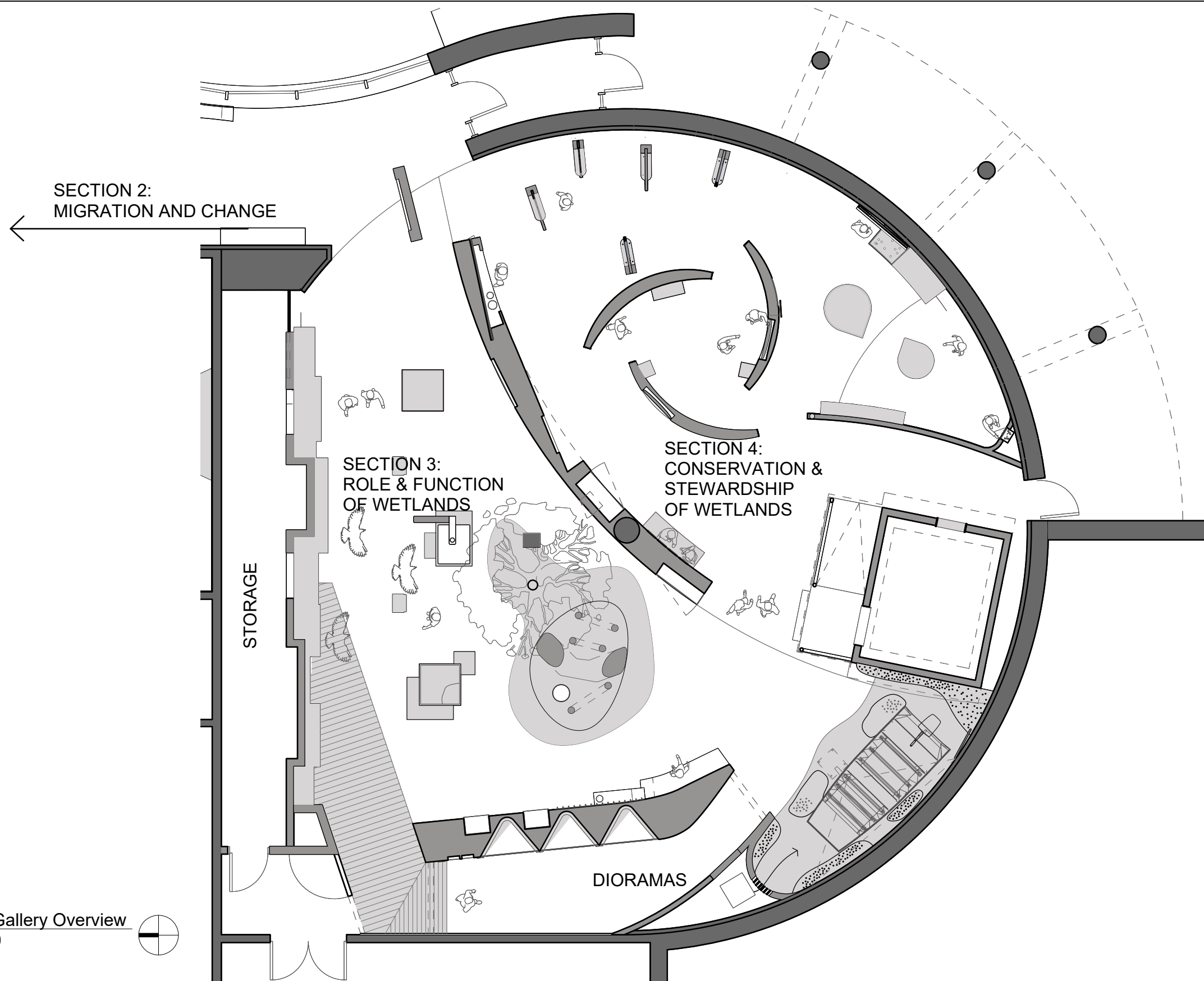

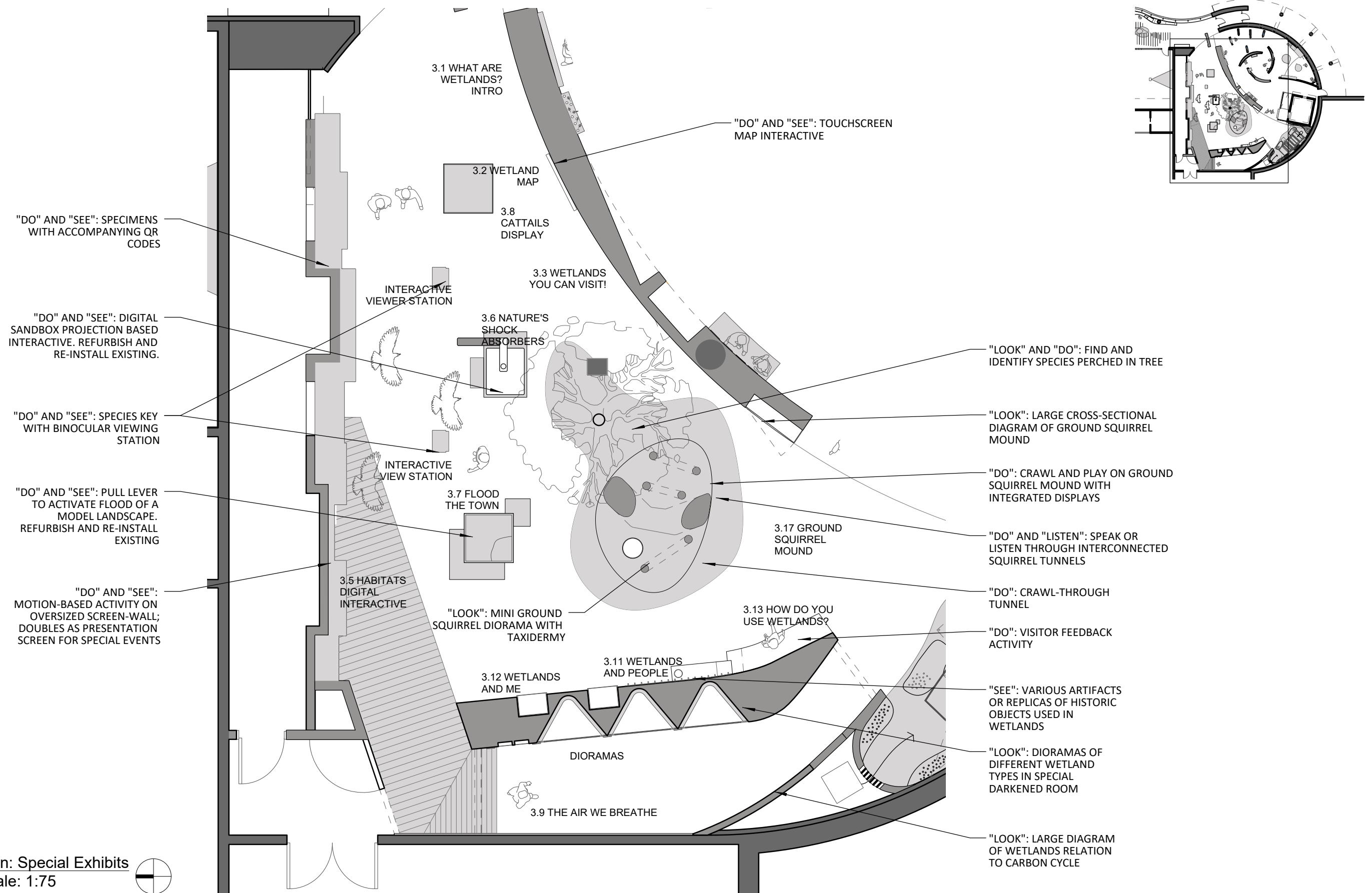

1 Plan: Special Exhibits
Scale: 1:75





1 Front Elevation
NTS



1 Perspective
NTS

SPECIES LOCATIONS AS SHOWN
ALL TEXT AND IMAGES
PLACEHOLDER ONLY

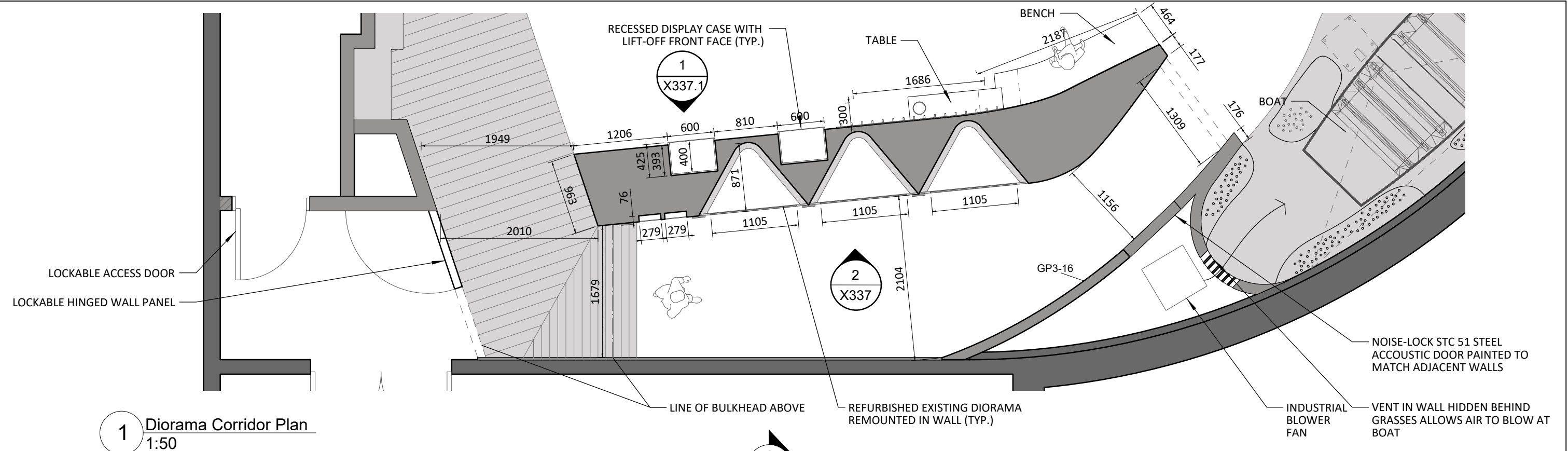

1 Diorama Corridor Plan
1:50

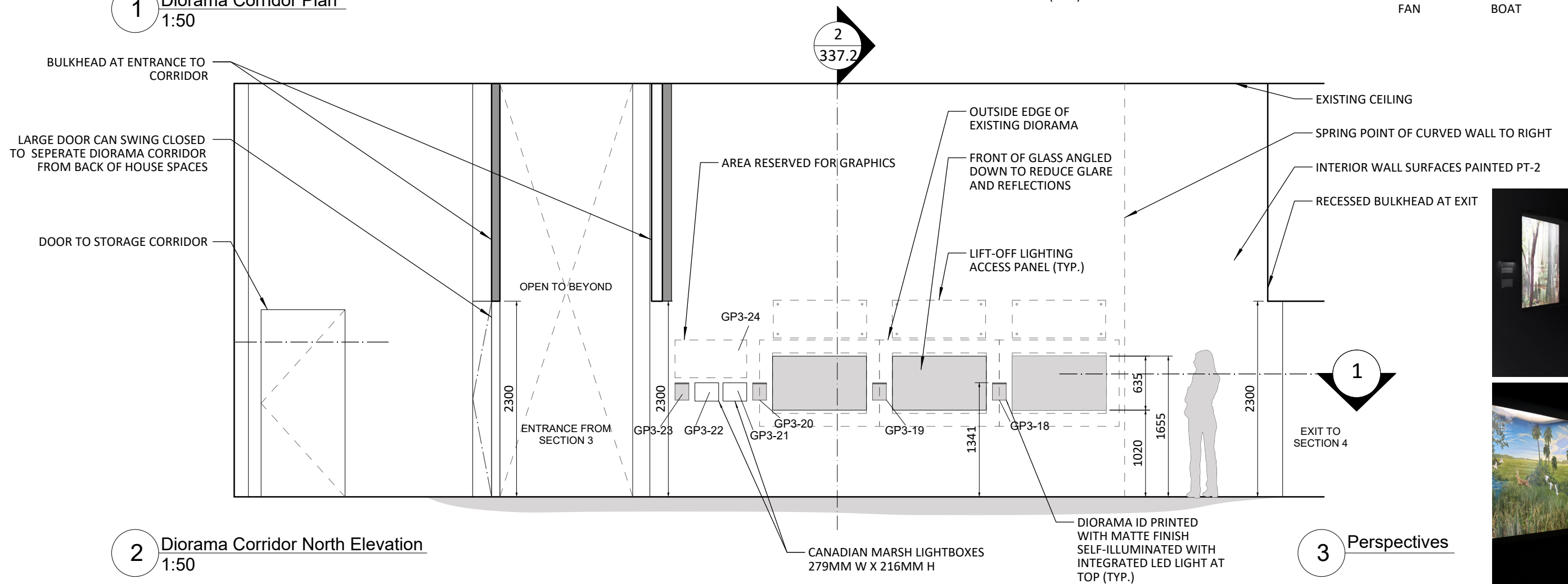

2 Diorama Corridor North Elevation
1:50

3 Perspectives

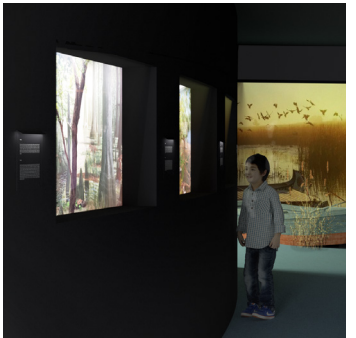

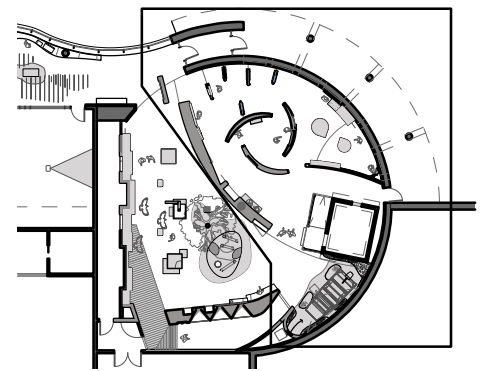
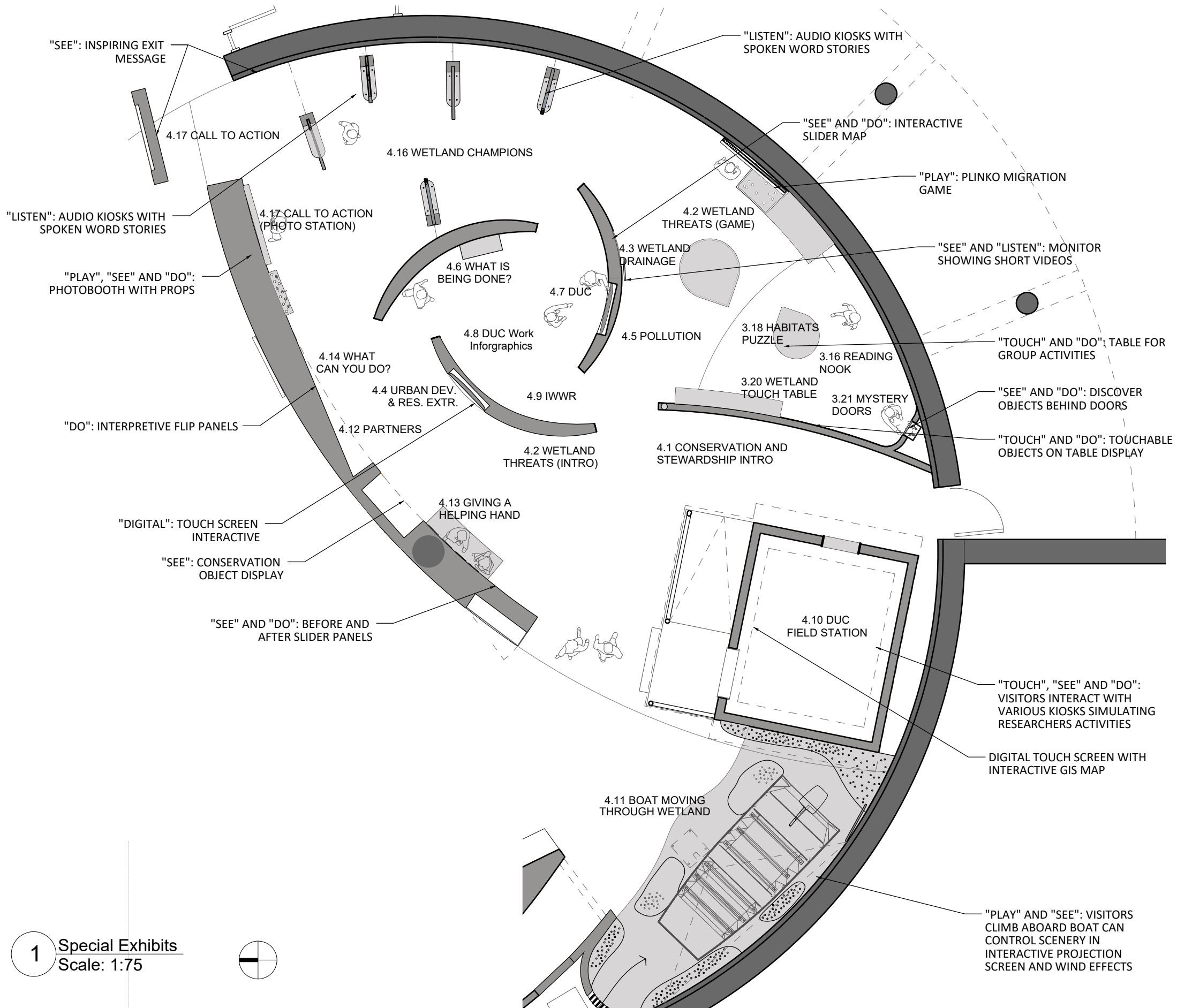

1 Special Exhibits
Scale: 1:75



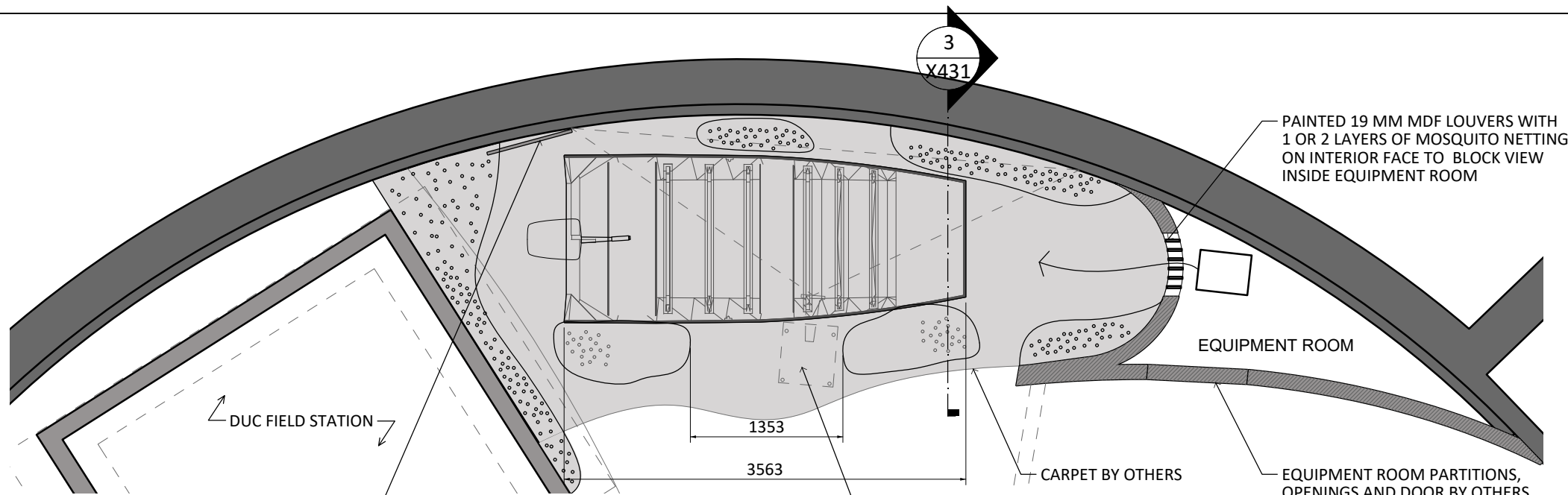

1 Plan
1:50

1
X431.2

4 Perspective (Not Exactly as Shown)
1:50



Render from October 15th presentation for reference. Included to indicate quality of the space.

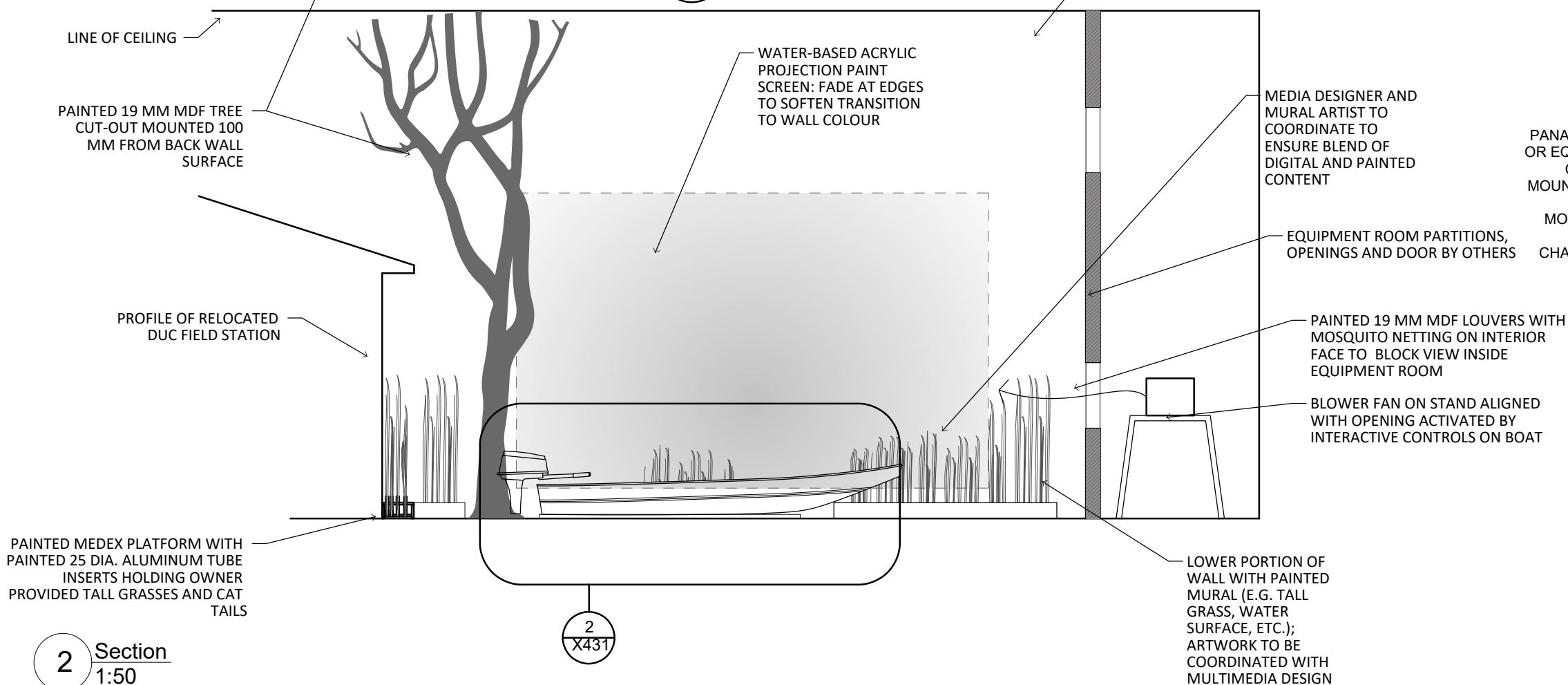

2 Section
1:50

PANASONIC PT-RCQ10 OR EQUI. MOUNTED TO CEILING; ENSURE MOUNT IS STABILIZED TO PREVENT MOVEMENT; POWER AND DATA TO BE CHASED TO SERVICE CLOSET

FINAL POSITION OF PROJECTOR TBD BASED ON MULTIMEDIA DESIGNER

GRASSES (OWNER PROVIDED) KEPT BELOW LINE OF PROJECTION

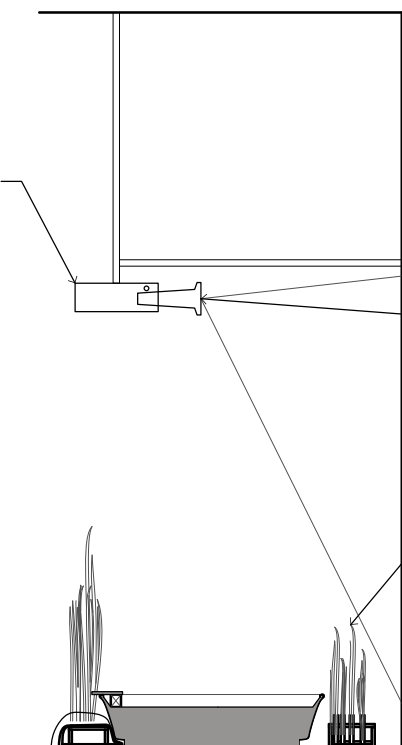

3 Unrolled Section / Elevation
1:50



- Existing cabin view for reference only. External graphics not in illustration.



- Items as shown above
- Small custom cubie shelf, 4"x4"grid by 4" deep, solid pine painted white
 - Microscope by owner placed on table
 - Bird banding activity as per special exhibits document
 - Four 8" deep mounted shelves on steel shelf bracket mounted to cabin wall. Props provided by owner.
 - Heavy duty 18" wall mounted bracket; solid pine painted white with hand held luggage scale
 - ¼" thick pvc cut-out fish silhouettes with full face vinyl prints. Qty: 10 unique silhouettes ranging from 6" long to 20" long.
 - White bucket in hole in countertop
 - Bird banding station as per special exhibits document



- Items as shown above
- Two (2) i-hooks in wall to hang clipboard left of fish scale bracket (no shown in illustration)
 - Purchased water testing kit with case secured mounted on angle and secured to table and back wall as shown. Custom cut ¼" thick acrylic secured to open face of case with tamper proof screws.
 - Wall mounted test tube drying rack mounted to wall
 - Custom printed ¼" place mat graphic.
 - Angled fish display with 3x ½" deep ledges, painted white



- Items as shown above
- 32" touchscreen in painted enclosure mounted to wall. (content by owner)
 - Two (2) 3' long purchased coat racks similar to illustration.





NEW WELCOME SIGN AT PARKING LOT

PHYSICAL ENHANCEMENTS



EXISTING



EXISTING



REDEVELOPED



REDEVELOPED

REMOVE ASPHALT AND REPLACE WITH NEW LIMESTONE SCREENING

NEW LIMESTONE BLOCK BENCHES/ VEHICLE DETERANTS

OUTDOOR DONOR PANEL

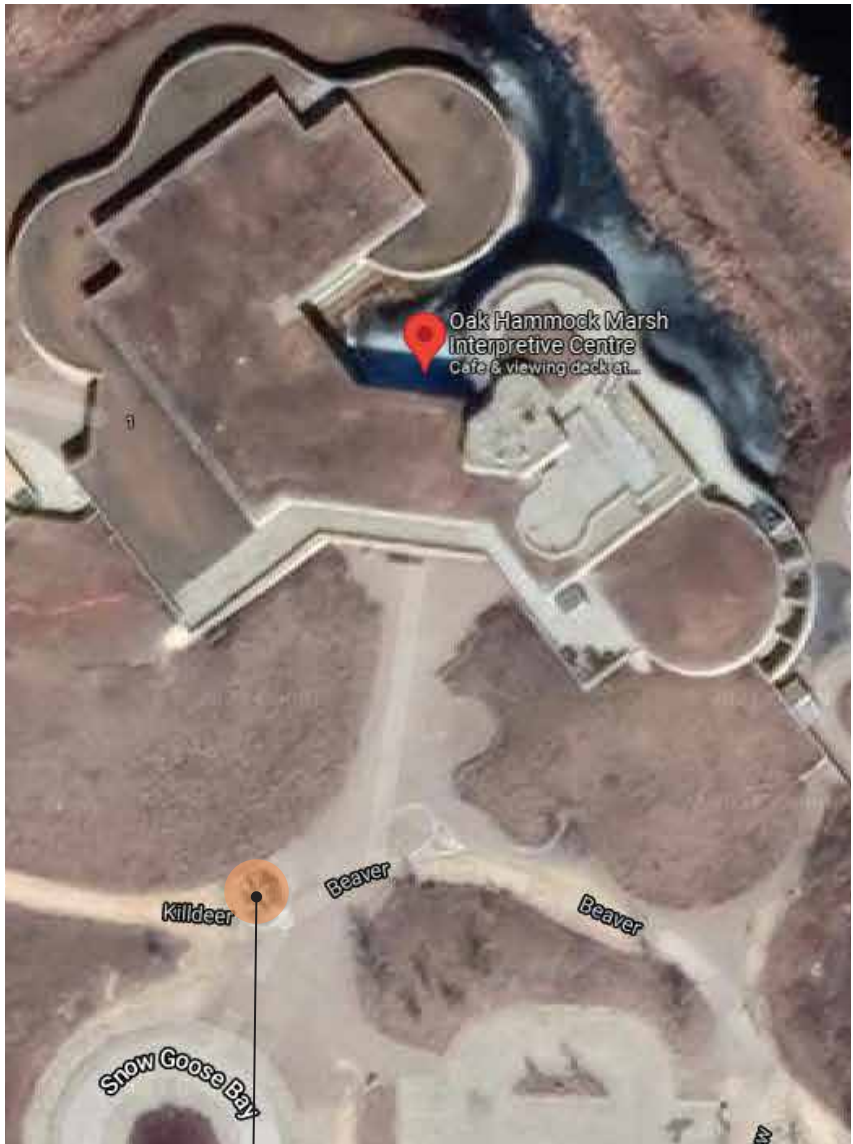

LOCATION OF NEW DONOR PANELS



REMOVE EXISTING PAVERS AND REPLACE WITH NEW LIMESTONE SCREENING AS SHOWN

NEW DONOR PANELS OVERLAID AND MOUNTED TO EXISTING. REFERENCE GRAPHIC DESIGN SOURCE GUIDELINES

- Remove existing fabric shelter
- Repaint steel ring
- Remove existing pavers at base to create a circular ring of gravel